

Jefferson Campus

Employee & Visitor Experience Improvements

Partnership Opportunities

TJU problem times

Employee shift changes

6:00 am - 8:00 am

3:30 pm - 7:30 pm

10:30 pm - 11:30 pm

Prime Visitor Hours

Monday – Friday

6:00 am - 5:00 pm

CCD On-street deployment

Cleaning crews

**Manual, mechanical, pressure washing, graffiti removal
7am to 3pm, seven days per week.**

Normal periods – 5-7pm in retail areas

Community Service Representatives

Sunday, Monday: 10 am to 6 pm

Tuesday - Thursday: 7:30 am to 10 pm

Friday & Saturday: 8:00 am to 10 pm

Sidewalk cleaning



Community Service Representatives



CCD Police Substation

Police & CSRs stand joint roll call



Added overnight security patrols from 8pm to 6am with Allied Universal vans in retail districts



Patrol supported by contributions from owners: east to 11th St. Exploring additional security deployment

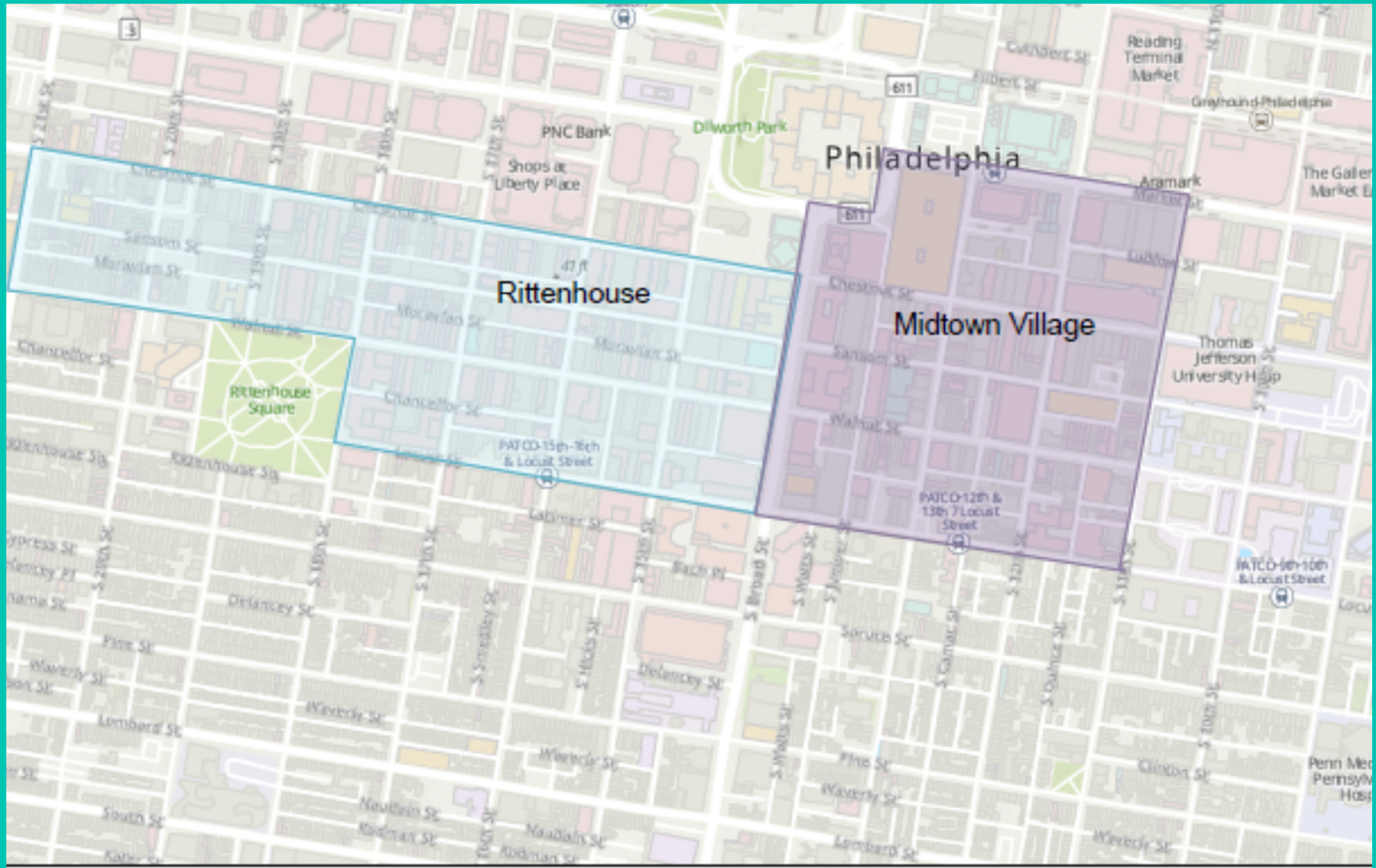

2018: Ambassadors of Hope: Combined outreach Project Home, CCD & Police



191 individuals came off street in 2019

Sidewalk behavior ordinance; no arrests or citations



Center City District Daytime Homeless Concentration - July 9, 26 Individuals



Focus Area
Market - Locust & 8th - 13th

Homeless Individuals



CCD Survey Boundary

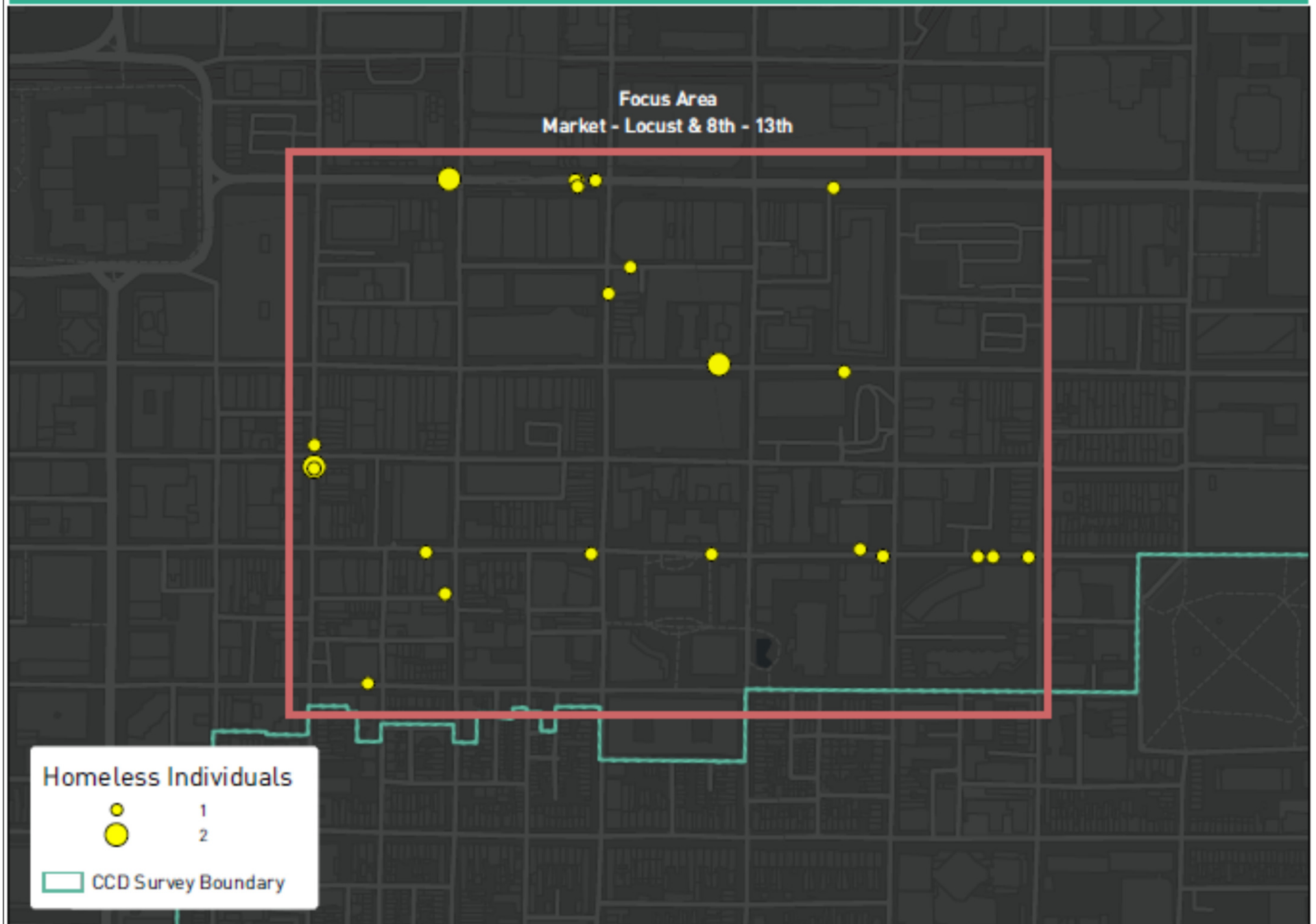

Center City District Daytime Homeless Concentration - July 9, 98 Individuals

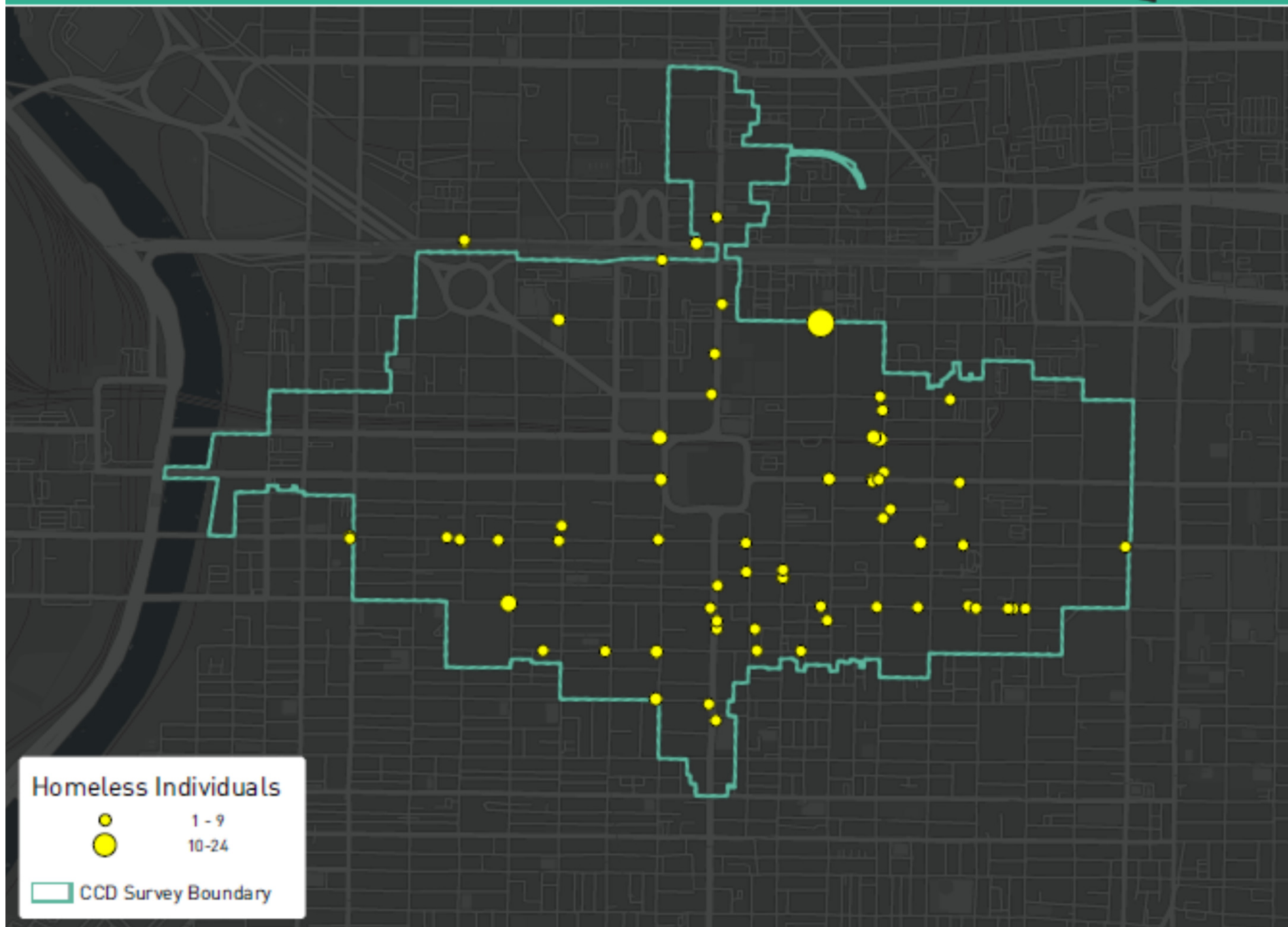

Homeless Individuals



1 - 9
10-24

CCD Survey Boundary

Homeless Outreach

- Focused CCD outreach effort around Jefferson campus?
- CCD outreach staff partnership with Jefferson Police?
- Homeless outreach program support from Jefferson's psychiatric facilities?



Pedestrian Lighting LED Upgrade

- CCD conducted survey of Jefferson Campus; Locust to Market; 8th to 12th
- Counted 333 pedestrian fixtures in need of upgrading to LED
- City not planning upgrades for at least 18 months to 2 years; Opportunity to expedite the replacement of the old fixtures, managed by the CCD

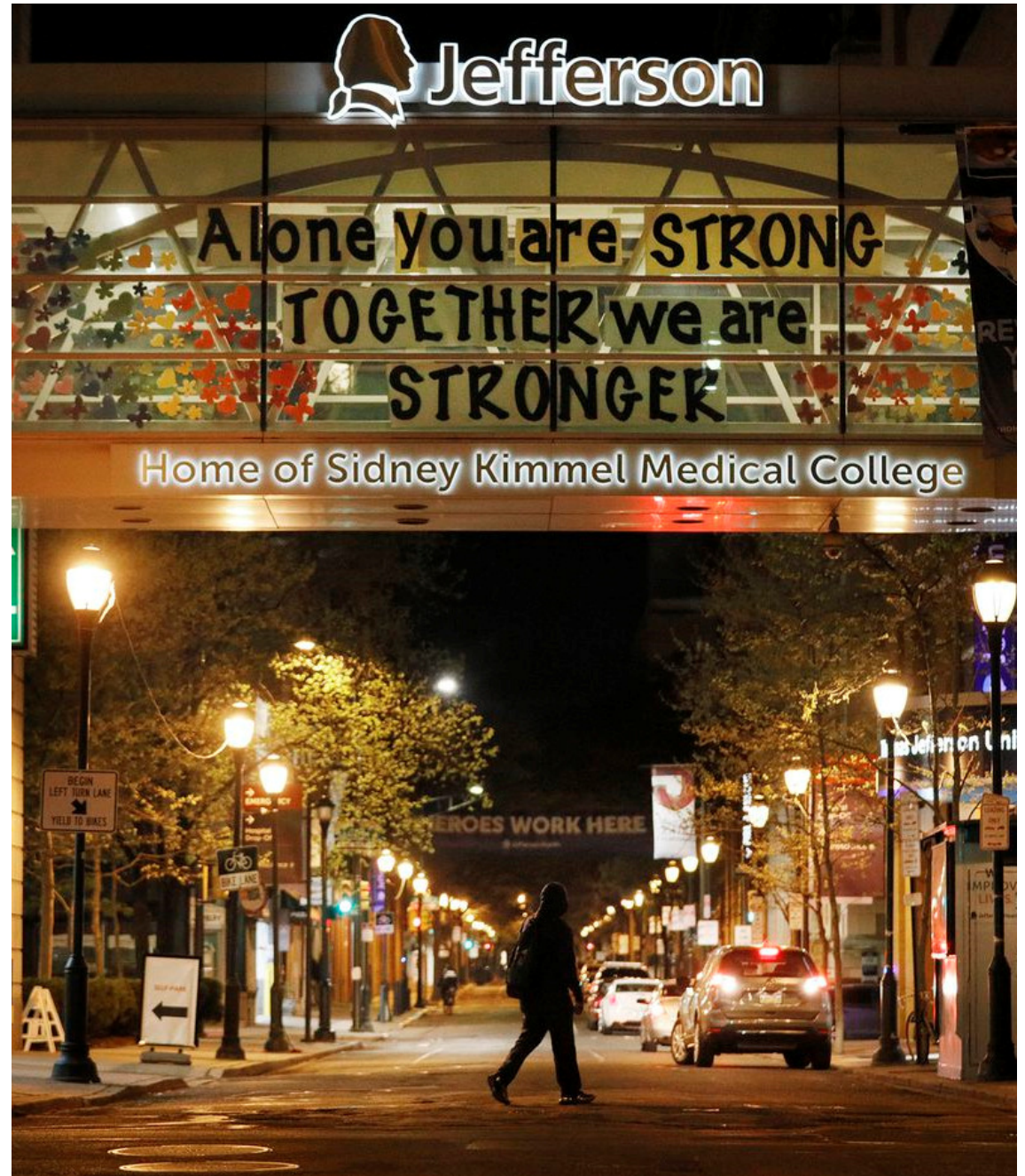

1

CCD installed 2,300 pedestrian-scale lights 1998-2019

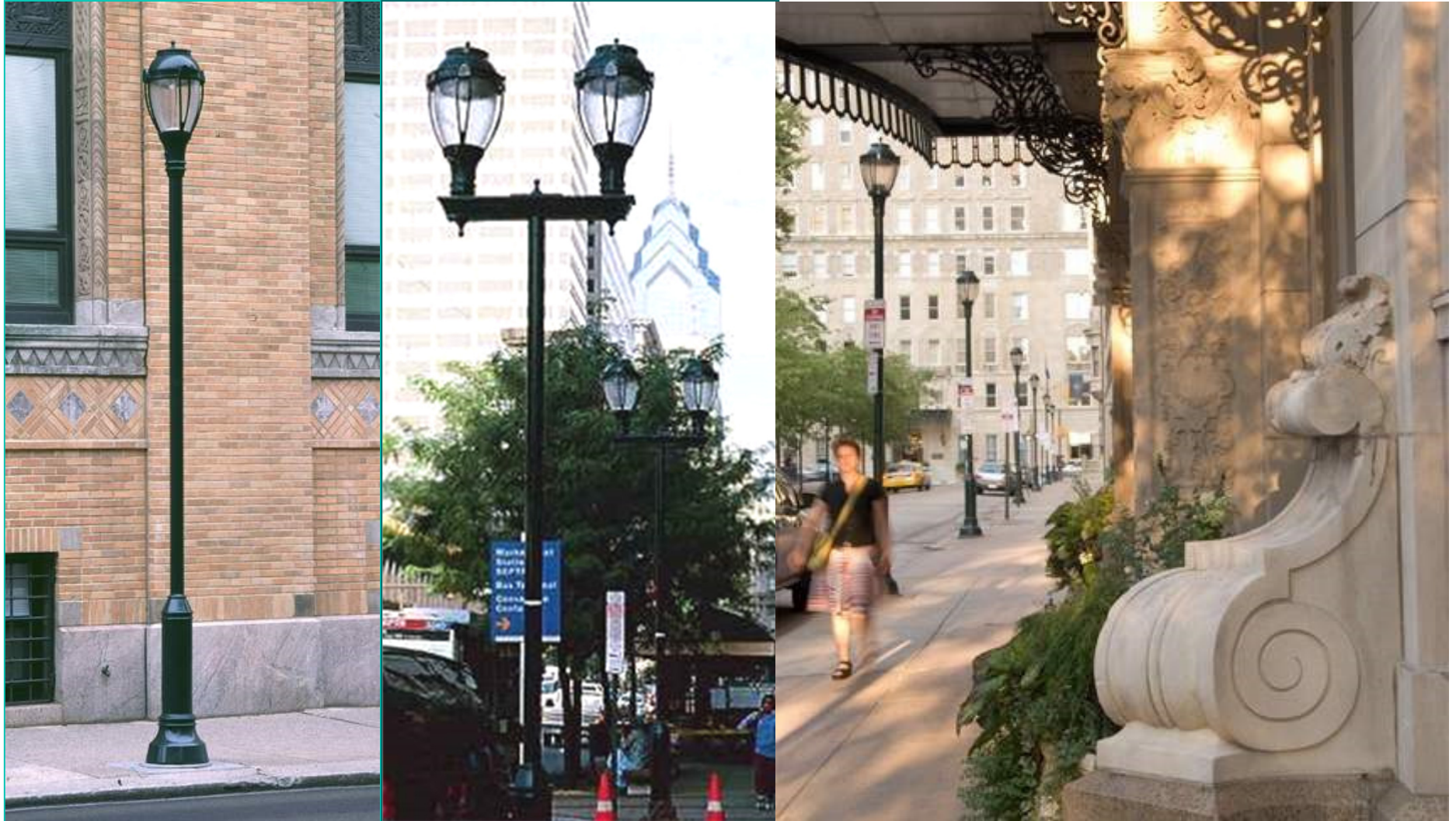

Pedestrian light fixtures, 75% of downtown sidewalks

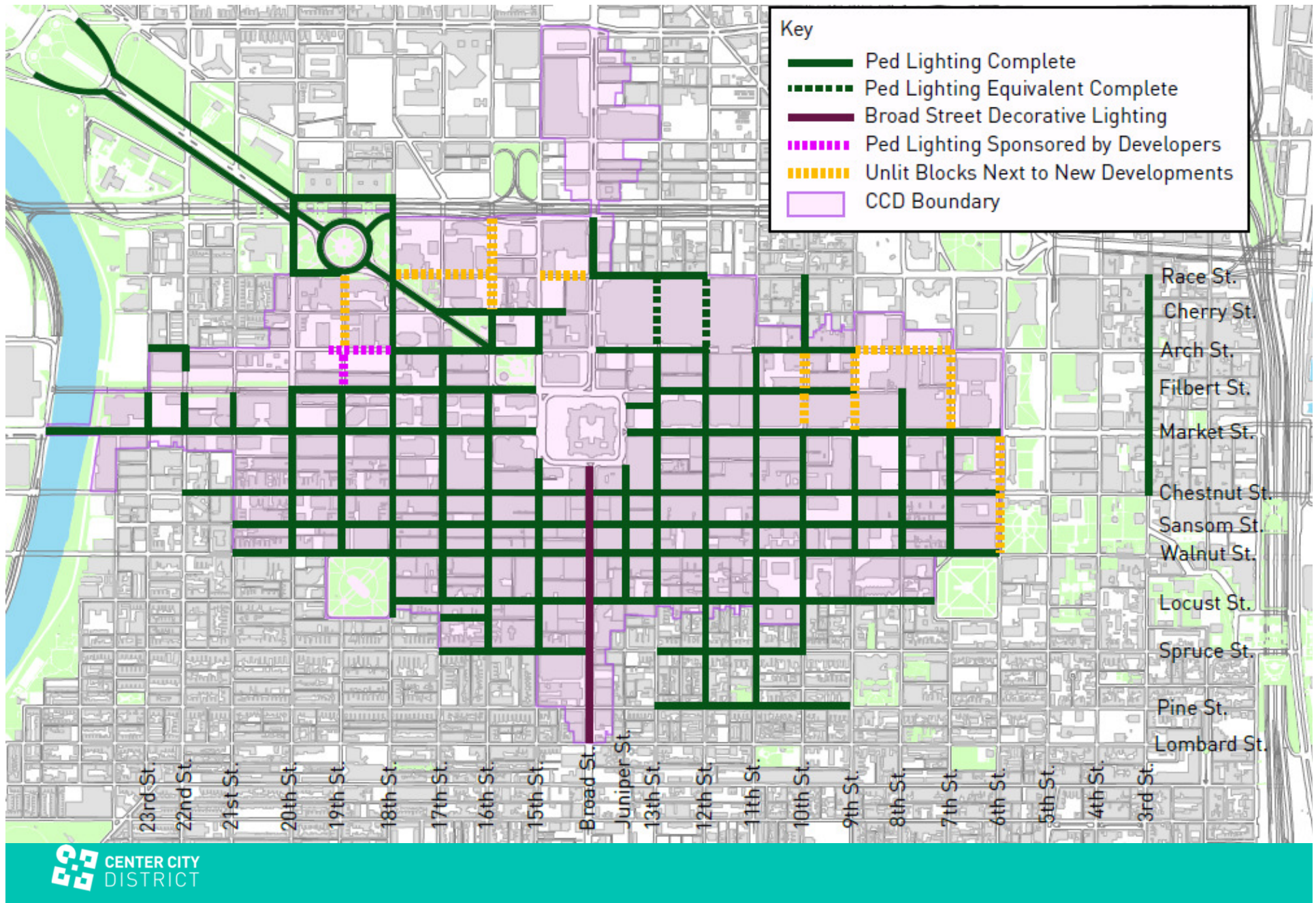

LED Pedestrian Lighting Review

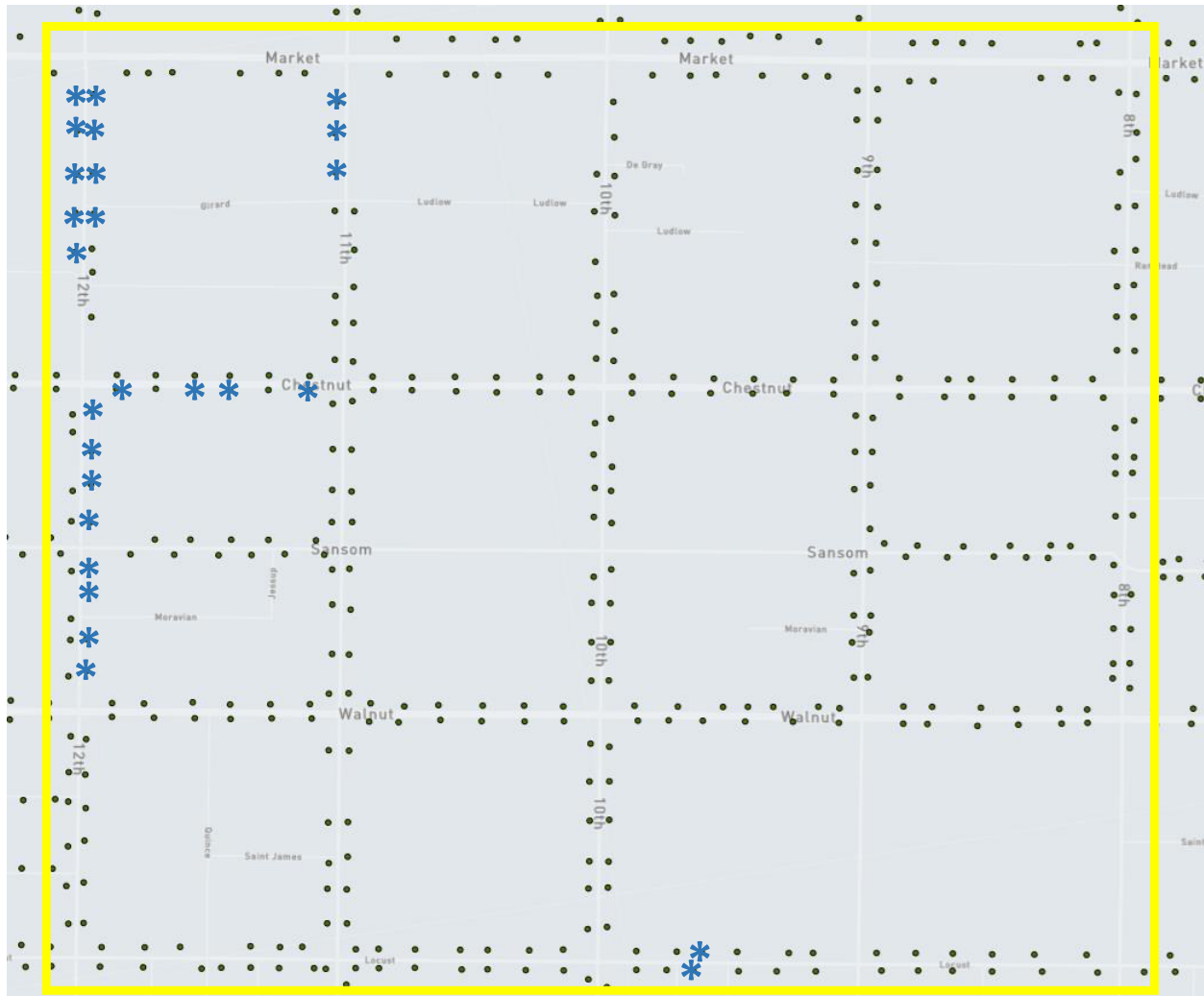

26 existing LED fixtures

333 replacement fixtures needed

* = Existing LED Pedestrian Fixture

LED Pedestrian Lighting Counts: unit costs \$2,750 installed

Pedestrian light counts (survey 07 17 2020)

| District bounded by Market, Locust, 8th and 12th Streets | Street | Total Units/Luminaires | LED Existing | Fixture Unit Upgrades | Cost for LED Upgrade Per Unit Installed | Total Cost LED Upgrade | |
|--|----------|---------------------------|-----------------|--------------------------|---|---------------------------|--|
| | Chestnut | 49 | 4 | 45 | \$ 2,750.00 | \$ 123,750.00 | |
| | Sansom | 23 | 0 | 23 | \$ 2,750.00 | \$ 63,250.00 | |
| | Walnut | 49 | 0 | 49 | \$ 2,750.00 | \$ 134,750.00 | |
| | Locust | 53 | 2 | 51 | \$ 2,750.00 | \$ 140,250.00 | |
| | 12th | 41 | 17 | 24 | \$ 2,750.00 | \$ 66,000.00 | |
| | 11th | 40 | 3 | 37 | \$ 2,750.00 | \$ 101,750.00 | |
| | 10th | 43 | 0 | 43 | \$ 2,750.00 | \$ 118,250.00 | |
| | 9th | 31 | 0 | 31 | \$ 2,750.00 | \$ 85,250.00 | |
| | 8th | 30 | 0 | 30 | \$ 2,750.00 | \$ 82,500.00 | |
| Total NS | | 359 | 26 | 333 | | \$ 915,750.00 | |

Pick priority blocks?

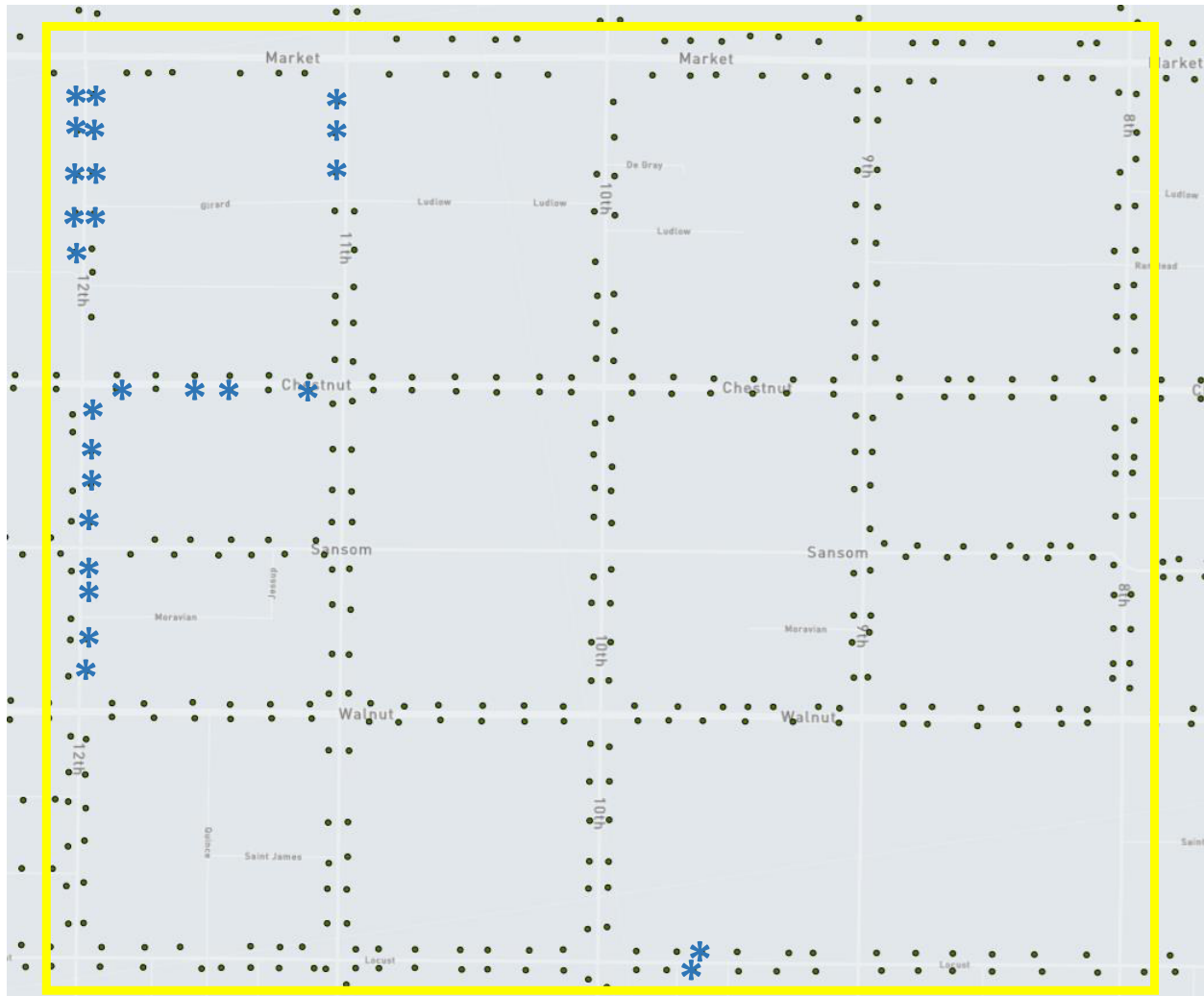

26 existing LED fixtures

333 replacement fixtures needed

* = Existing LED Pedestrian Fixture

Street Tree Replacement Program

- **Dead or missing trees along the perimeters of the campus.**
- **CCD offered on 2.21.20 assistance with Jefferson's tree program, including replacement of dead or missing trees & potential for long term maintenance agreement**
- **15 new tree pit opportunities were identified for Fall planting through our Plant Center City tree program**



Jefferson Campus Tree Planting Opportunities

REPLACEMENT TREES:



NEW TREES:

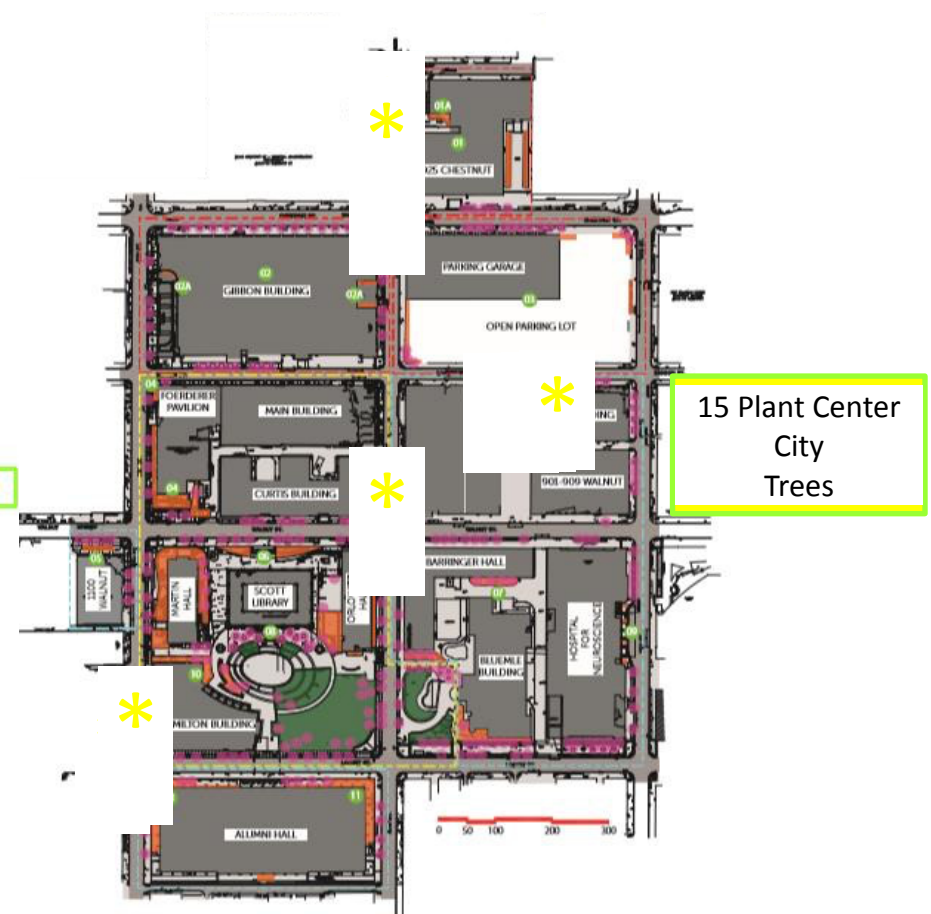

Recent Plant Center City Tree Installation

BEFORE



AFTER



Jefferson Campus Tree Planting Opportunities (Renderings)

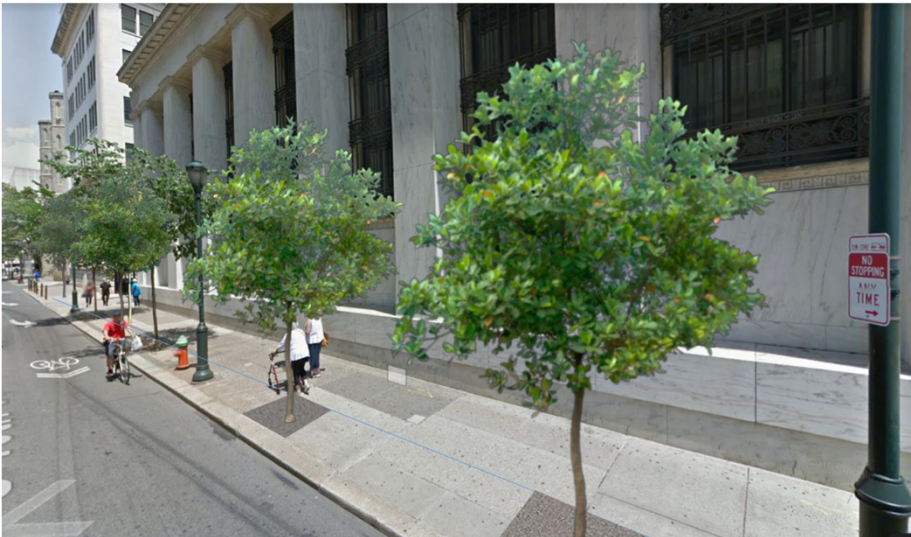

Jefferson Campus Planting Beds



Landscape Upgrade & Maintenance

- Many of sidewalk adjacent planting beds along Jefferson's properties are under-maintained & have potential to become a great amenity to the Jeff campus
- CCD can reach over the property line to clean litter out of planting beds on short term basis
- Landscape maintenance fee-for-service program? Could include installation of new plant material, seasonal changes, cleaning & maintenance schedule



CCD: extensive experience with maintaining planting beds



Landscape team oversees contractors



Manage our own planters & growing inventory of fee-for-service planters: Wawa & Avenue of the Arts,



Brickstone 1100 block of Chestnut



Street Banners

- CCD manages Jefferson's long-term banner program
- There are 37 banner poles locations on Jefferson's campus; spring deployment skipped; summer expected soon



37 banner poles on Jefferson's campus



925 Chestnut Street Pocket Garden

- Gated pocket park at the Sidney Kimmel Cancer Center has great untapped potential
- Formal garden, designed by Paul Cret added to Federal Reserve Building in 1941
- Landscaping & animating this space would create welcoming experience for visitors
- Potential management partnership with CCD



CCD's John F. Collins Park at 17th & Chestnut



Animating ground floor retail spaces 1000 Block of Chestnut

**Animate sidewalks with
more food, entertainment &
retail options for students,
faculty & visitors**



Potential for Campus Animation

